



**RAKTANK**  **50**  
WATER TANK



**Fit Kit for Rhino Pioneer Platform Rack**  
**Part Number # RTFKRHINOPIONEER**

Prior to use, it recommended that the tank be thoroughly washed with mild dishwashing detergent and allow to air dry completely.

# Important Safety Information:

1. The water tank must be mounted completely flat on the mounting surface (slats and/or cross bars).
2. For your safety, only use a roof rack or cross bars that are approved for your vehicle. The (off-road) dynamic weight rating must be greater than the weight of the water tank at full capacity (including mounting kit and traction boards). Always consult your vehicle and roof rack manuals and ensure you are following their advice regarding on-road and off-road load limits.
3. Periodically check that all nuts and bolts that secure your water tank to your vehicle are torqued to specification and in good repair. Note: Large ambient temperature fluctuations can result in loss of tension of the mounting hardware.
4. Improper installation or use of your water tank may result in serious injury or damage. You will need to follow these installation instructions carefully to ensure proper installation on your vehicle and safe use of your water tank.
  - a. If the tank has been fitted to a vehicle that has been in an accident, the tank and mounting hardware need to be inspected before next use. For any queries regarding the ability to use the product after an accident, contact Pak Offroad at [info@pakoffroad.com](mailto:info@pakoffroad.com)
5. Make sure that you give due consideration to the change in your vehicle height and driving behaviour.

The manufacturer is not liable for any damage or accident that may occur as a result of a non-compliance with these usage instructions, modifications made to parts or the usage of any parts other than the manufacturer's original parts. The warnings, cautions and instructions in this document can't cover every possible situation, so it is understood by the operator that common sense and caution must be applied.

The manufacturer's warranty covers manufacturing faults and lasts three (3) years within regular use. It is only valid if the instructions and recommendations in this document are adhered to and only applies to the first owner.

# Installation of the fit kit:

Step 1: Installation of the mounting pins for the traction boards to the tank.

- Lay the tank on an easy to reach table at a good working height.
- Follow the exploded view of the mounting of the required pins.
- Please note: **Spending the extra time to make sure that the pins are correctly aligned and that the traction boards can be removed easily is beneficial.**

Maxtrax Mounting Pins (Part Number # MTXMPS40) exploded view:

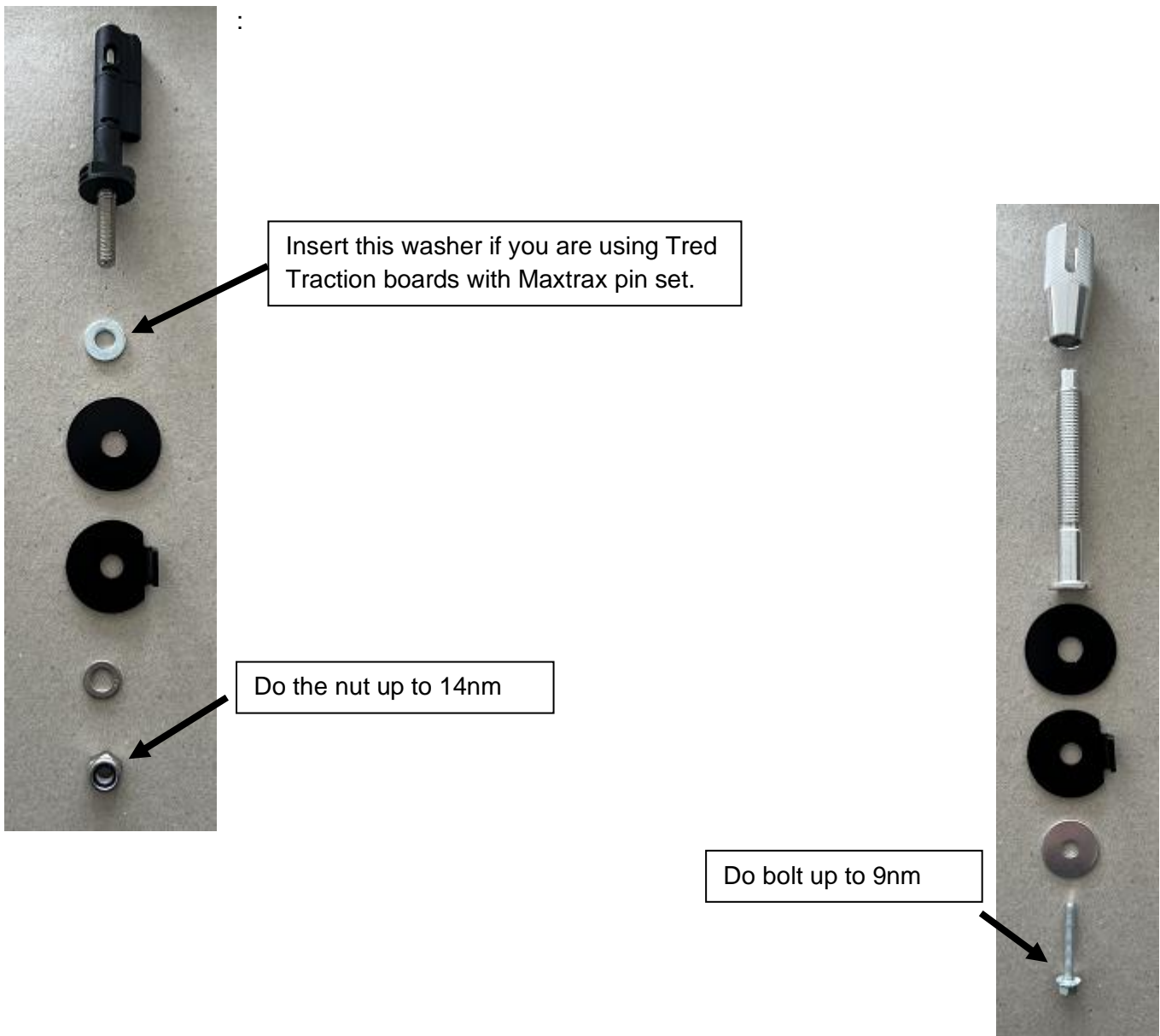

Tred mounting pins exploded view:



Please have the tongue of the bottom lock washer facing upwards

Your traction boards should look like the image below:



Step 2: Mounting the tank to the Roof Rack:

- Assemble the two mounting plates as pictured below.



- You will need to slide the 2 x

M10 x 90 bolts through the mounting plate and attach with a nyloc nut done up to 44nm. Then **loosely** assemble the channel nut with the M10 x 25 bolt and M10 high tensile flat washers. See the image below.



- Then slide these mounting plates into the desired T Slot of the platform rack. These can be mounted on the far outside slat and first inside slat or can be mounted to any of the larger slats, which is the desired mounting method. See the images below.
- **You will notice that the holes are offset and that you will need to have the bolt that is closest to the fold in the mounting bracket pointing towards the RHS of the vehicle.**

Outside slat and first inside slat mounting

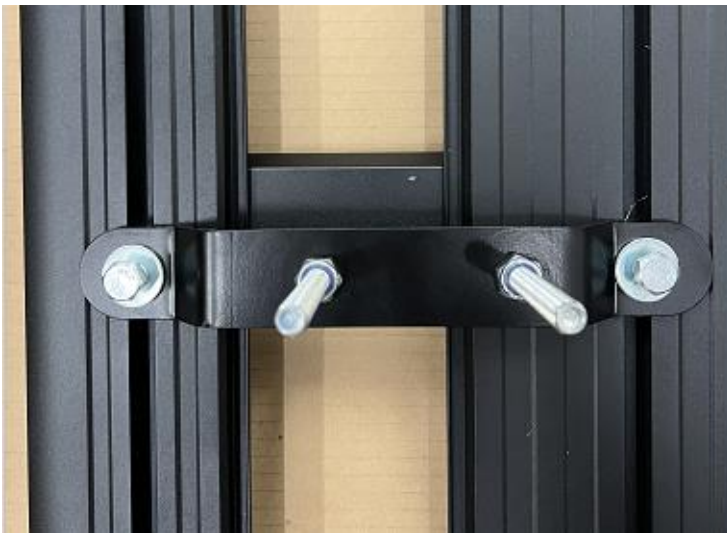

Larger slat mounting below is the **preferred mounting**





- Once you have the mounting plates fitted into the T slots then position the tank next to mounting plates and then line up the two east/west facing baffles on each end of the tank. See the image below.



- Once you have lined up these two baffles, do up the bolts through the T slot and fit the tank on top of the mounting plate. Make sure that the bolts are central to the baffle hole and that they are not touching the tank in any way. See the image below.



- Next you will need to fit the backing plates to the bolts. See the image below.



- Push the tank as far as possible to the RHS of the vehicle and then fit the M10 high tensile washer and nyloc nut to the bolts. Then do up to 12nm.



- Once you have fitted the washes and nuts allow to sit and check tension over the bolts again. You will need to check the tension of the nuts after installation. This should be done periodically. **Large ambient temperature fluctuations can result in loss of tension of the mounting hardware, so check the tension of the mounts.**
- If fitting this for a customer, please remind them of this requirement and supply a copy of the user manual to them.
- Place the traction boards on the top of the tank and installation will be complete.
- Any questions, email [info@pakoffroad.com.au](mailto:info@pakoffroad.com.au)

